

Latrine Installation Manual

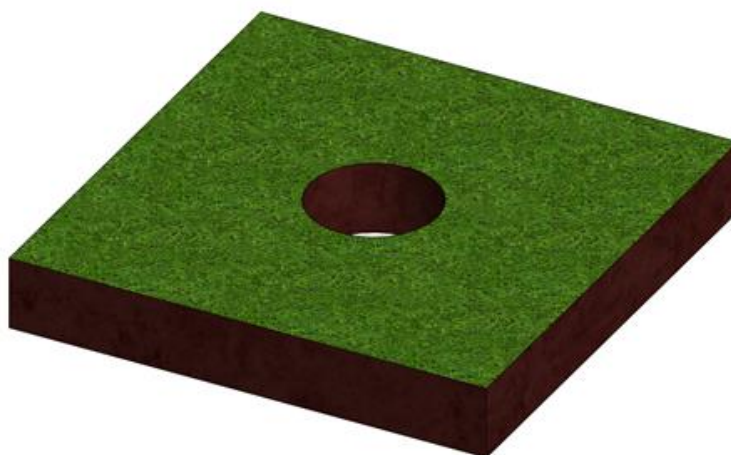

Note:

- **Must be dug within the template.**
- **All dimensions are in millimetres.**
- **Note. The longer side of the pit will be the front.**

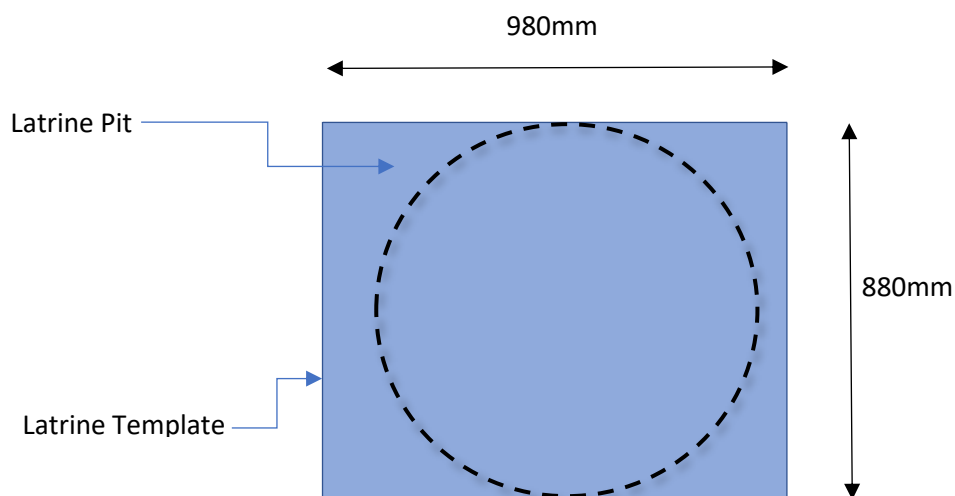
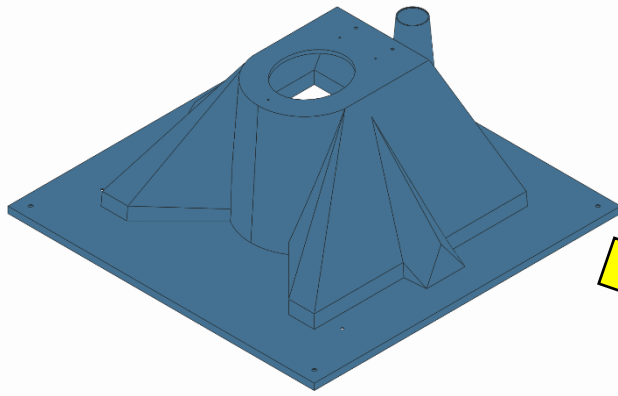

1. Insert the S-Trap component from underneath the slab and riser ensuring that the holes are aligned properly before bolting them with M6 cuphead bolt and nut.

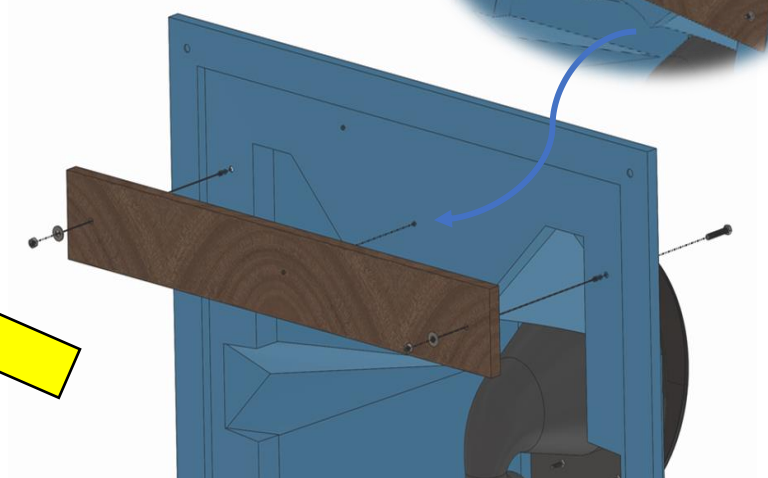
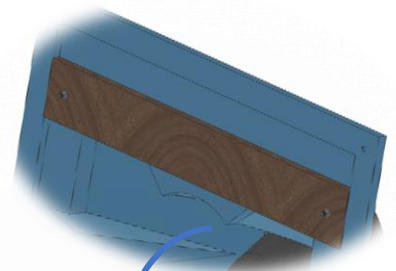
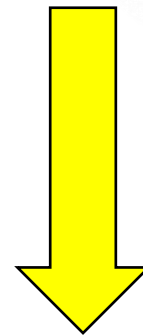
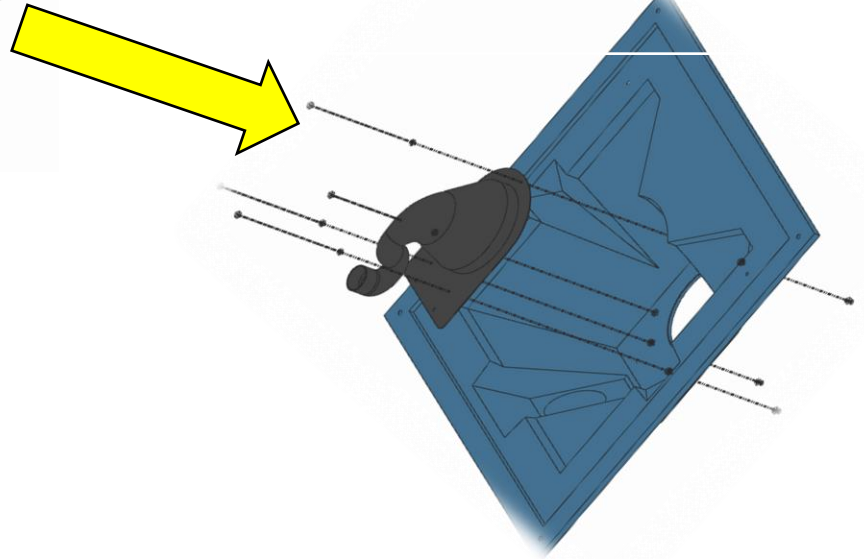

2. Attach the timber onto the bottom of latrine slab and riser and bolt it in on both ends with a M8 bolt & nut.

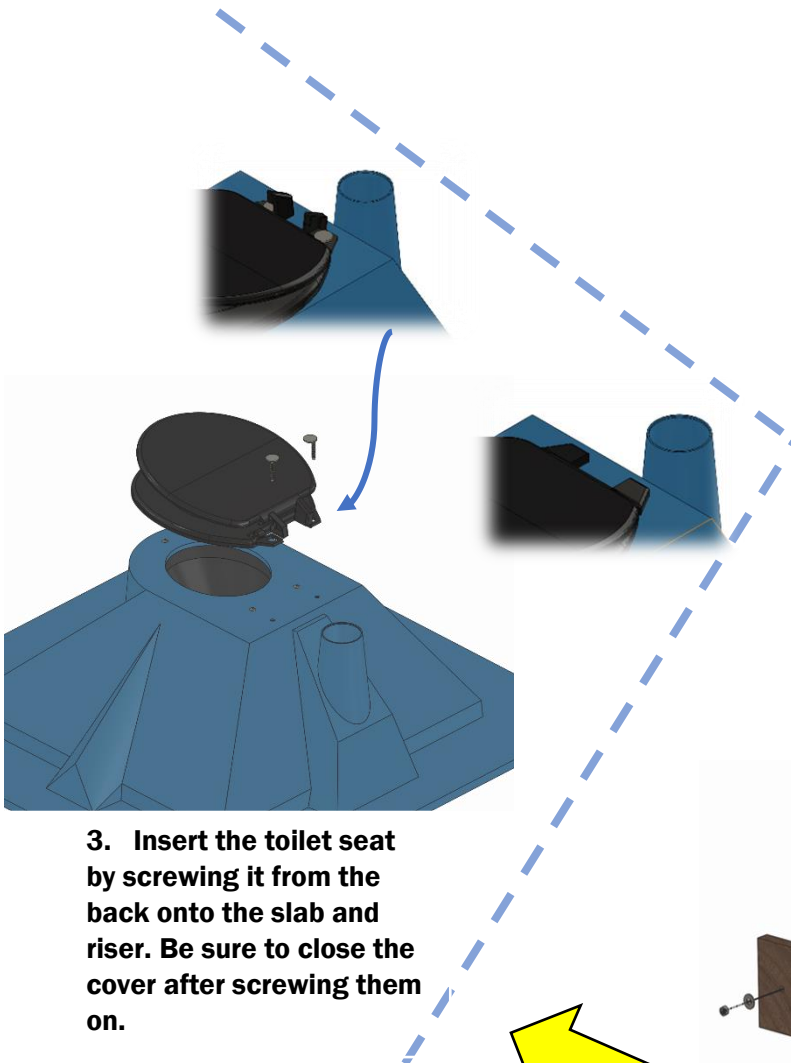
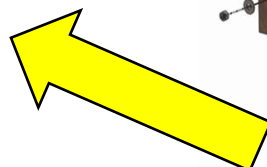

3. Insert the toilet seat by screwing it from the back onto the slab and riser. Be sure to close the cover after screwing them on.

4. a) Place latrine over the pit.

b) Ensure it is centred to pit

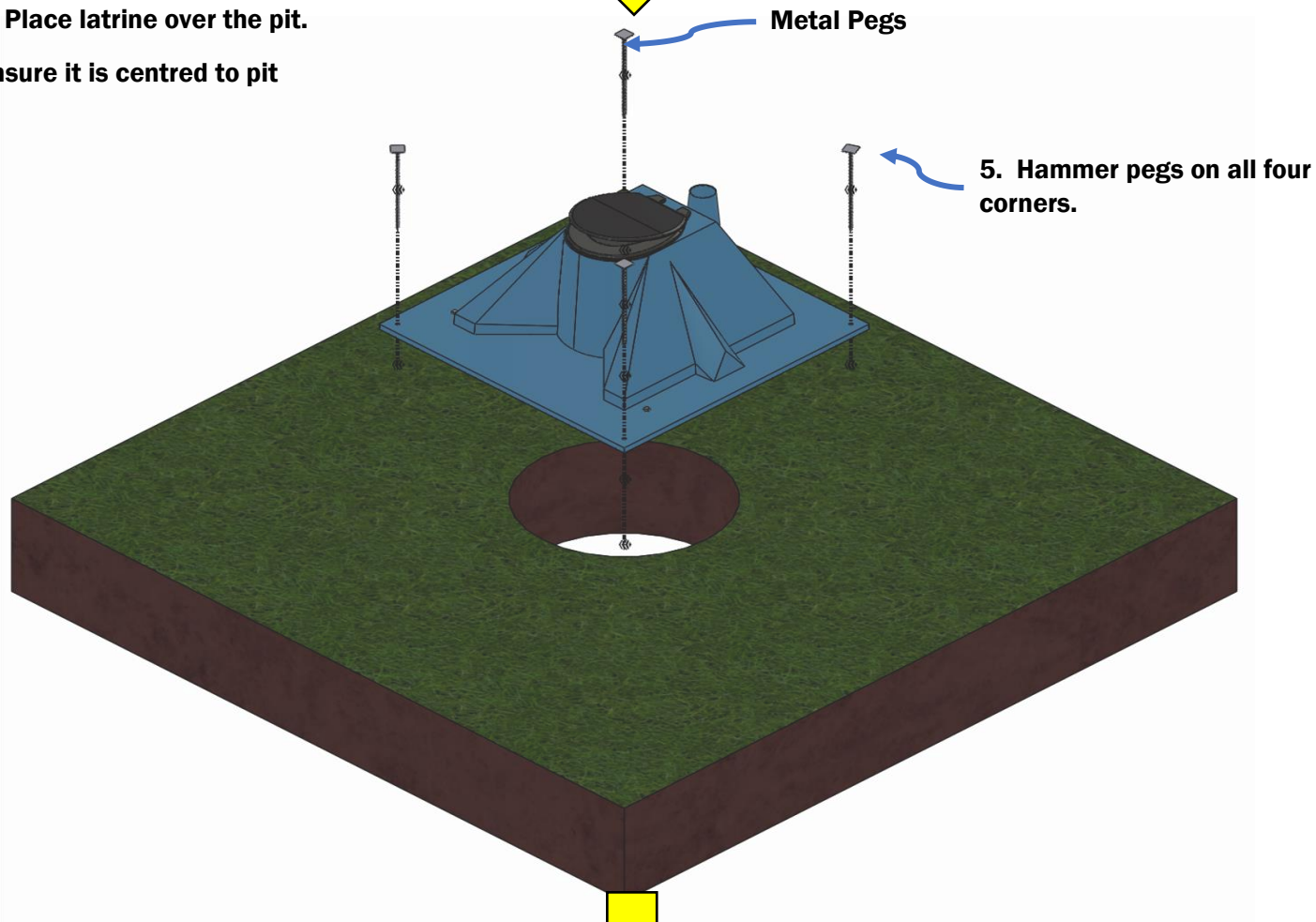

5. Hammer pegs on all four corners.

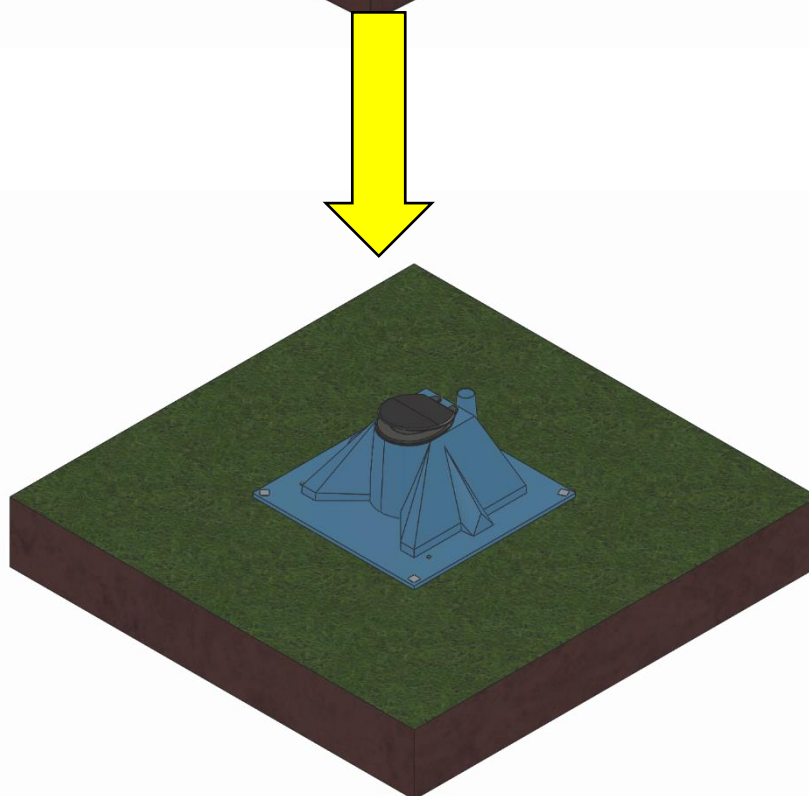

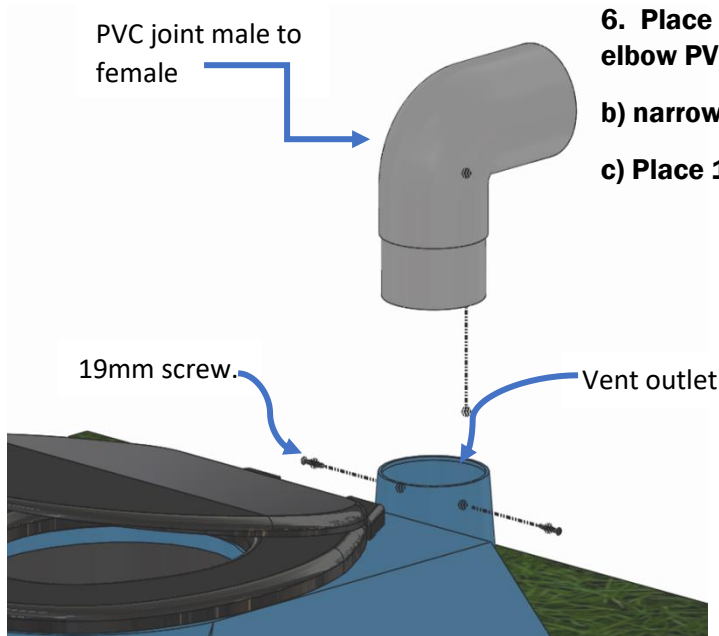
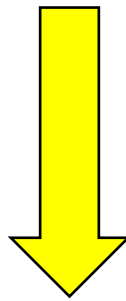

6. Place the Male – Female elbow PVC joint to the Vent

b) narrow end fits into vent

c) Place 19mm screw to fix

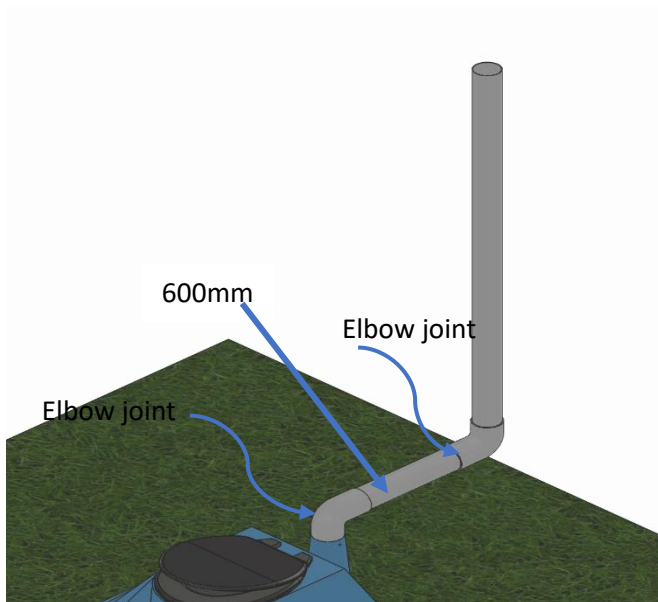
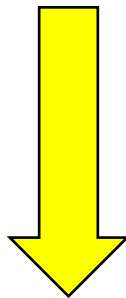
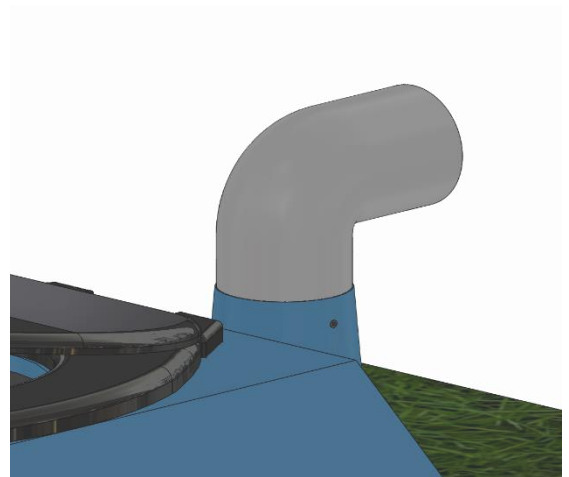

7. Connect the 600mm PVC pipe to the - female elbow as shown in the picture above.

Note: The 600mm PVC pipe length varies and is cut according to the length from the latrine to the back wall of the superstructure.

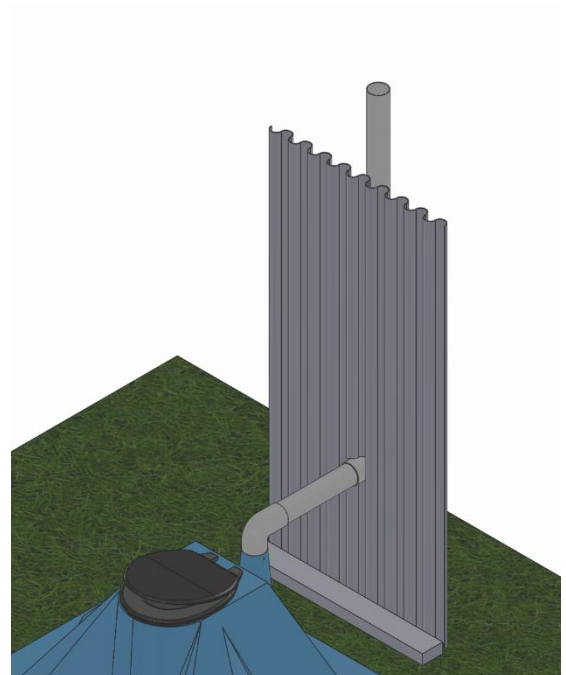

8. Fix vent pipe to external wall.